

# SARGENT®

XC  
SERIES  
CYLINDERS

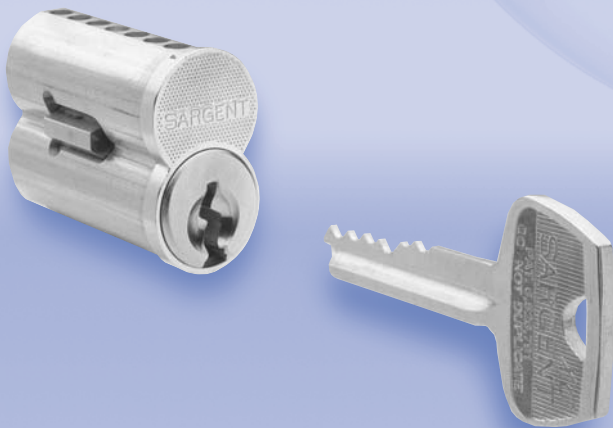
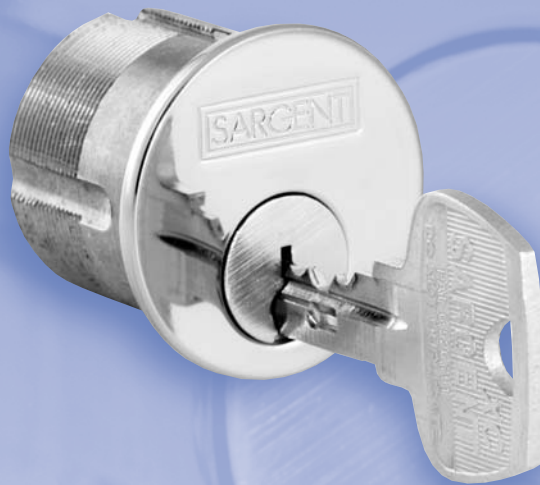
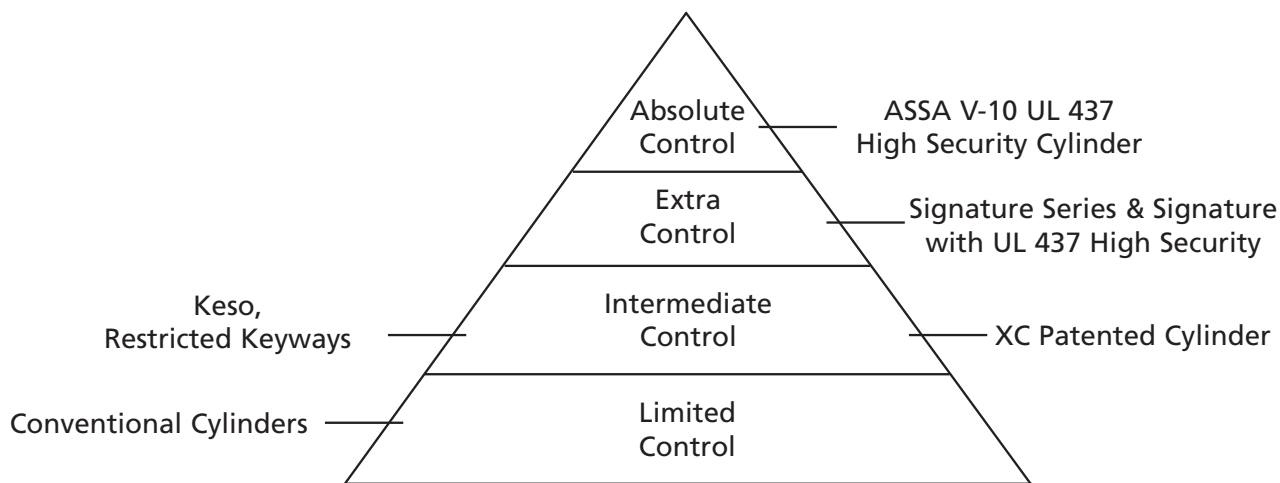

**Table of Contents**

**Page**

Key Management Software	1
Features, Benefits & Components	2
Bored and Auxiliary Lock Cylinders	3
Mortise/Rim Cylinders, Rosettes & Blocking Rings	4
11-7300B Interchangeable Cores	5
Construction Master Keying & Padlocks	6
Key Control Comparison & Key Blanks	7
Visual Key Control & Tamper Proof Packaging	8
Architectural Specifications/How to Order	9

**SARGENT's Pyramid of Cylinder & Key Control**



See product catalogs for more information

**On the Cover**

11-41 Mortise Cylinder  
11-7P-7300B Small Format Interchangeable Core

# XC Series Key Management Software

**SARGENT**

1-800-727-5477

www.sargentlock.com

## *SARGENT'S KeyWizard™ Software Package Tracks Multiple Key Systems, Including Keys, Keyholders, Locations, and Hardware Information*

This comprehensive key management software package was developed for locksmiths and end-users to track detailed information. The program features easy to navigate, non-cluttered screens and uses a format similar to Microsoft® Outlook™.

### Features:

- Free technical support & free upgrades for one year
- Clear easy to read screens
- Multi-level password protection
- Manages multiple end-users and multiple key systems for most manufacturers
- Customized query, reporting, and search capability
- Global key search across multiple masterkey systems
- Comprehensive hardware listings for door locations
- Displays keyholder photos and signatures for identity verification
- Automatic reminders for maintenance, back-ups, and overdue keys
- Accurate key symbol sorting
- Key authorization tracking
- Customized key receipts and authorization forms
- Tracking of loaned keys and key deposits
- Stores maintenance service history records
- Importing of key systems, keyholders and locations
- Exporting of key systems and locations
- Network and stand-alone versions available



By **SARGENT®**

How to Order:	Part Number
Single License Version	<b>KW-SS1</b>
Network Version	<b>KW-SSN1</b>
Demonstration Version	<b>KW-DEMO1</b>

KeyWizard floppy disk  
with new masterkey system **DLKW1**  
(when purchased with hardware)

KeyWizard floppy disk  
with existing key systems\* **DLKW2**

KeyWizard replacement for KeyMinder  
(Consult factory for eligibility requirements)

Single License Version	<b>UP-KW-SS1</b>
------------------------	------------------

Network Version	<b>UP-KW-SSN1</b>
-----------------	-------------------

\* Please consult factory for the availability of existing systems for use with KeyWizard.

### Computer System Recommendations:

#### REQUIRED:

- 350 MHZ processor or greater
- Windows® 98, 2000, ME, NT or XP
- 16 MB RAM
- CD Drive
- Mouse pointing device
- 60 MB hard disk space

#### RECOMMENDED For Better Performance:

- 500 MHZ processor or greater
- Windows® 98, 2000, ME, NT or XP
- 64 MB RAM
- CD Drive
- Mouse pointing device
- 70 MB hard disk space

# XC Series Features, Benefits & Components

**SARGENT**

1-800-727-5477

www.sargentlock.com

## Features

- Patented product with key blanks only available through authorized SARGENT distributors
- Available in finished locks, complete cylinder assemblies and shell/plug components
- Available in several standard SARGENT keyways
- XC keys can be cut to operate non-XC cylinders. Easily field cut on standard key duplicating machines
- Available for most SARGENT lock products in conventional, construction and SFIC cylinders
- Small Format Interchangeable Cores in SARGENT 4A & 4B

## Benefits

- Increases security and key control by limiting unauthorized duplication
- Versatile design for new systems, retrofits and easy field maintenance or construction keying
- Cost effective method to increase security of existing systems without having to install a complete new system
- Security of a system can be increased where needed without having to issue all new keys
- Maintain and expand existing key systems using similar SARGENT products
- Fast, easy change of keying without having to disassemble the lock from the door or cylinder from knob/lever

## Components

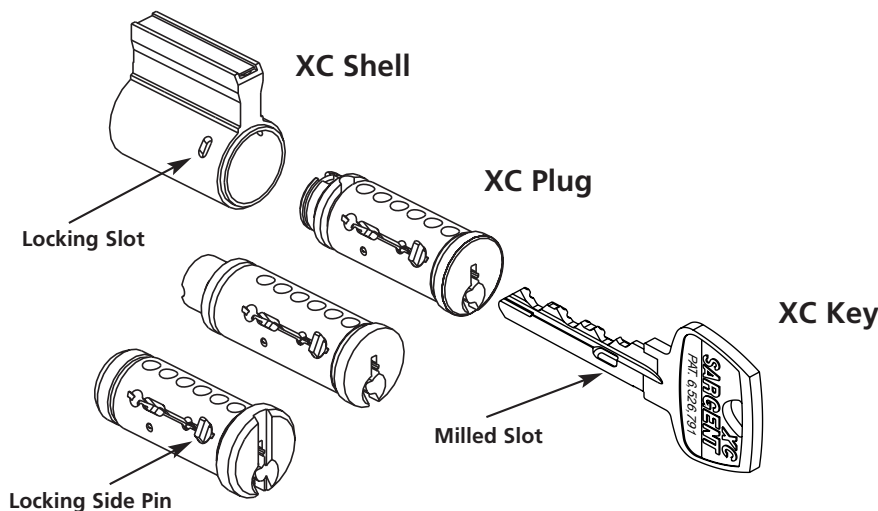

### XC Shell\*

A locking slot is machined into the XC shell for the plug's locking side pin to engage in. The locking pin is normally inserted in the slot, preventing plug rotation. With a properly cut and side milled XC key inserted, the plug rotates freely in the shell.

### XC Plug\*

Factory loaded with the locking side pin mechanism. The locking pin extends into the XC shell, preventing rotation, until a properly cut side milled XC key is inserted.

### XC Keys\*

The XC key has a side milled slot to operate the locking side pin mechanism in the plug. Location of the slot varies with keyway used; standard key cutting can be easily be done in the field and XC keys will operate standard SARGENT non-XC cylinders. Two keys are provided standard with each cylinder.

\* U.S. Patent No. 6,526,791

# XC Series Bored & Auxiliary Lock Cylinders

**SARGENT**

1-800-727-5477

www.sargentlock.com

## Shell & Slide Assembly

## Plug Assembly

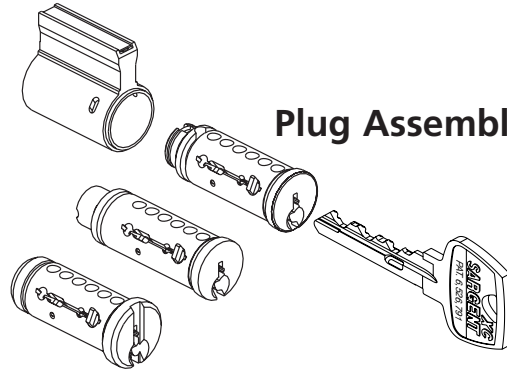

### Bored Locks

Locks	Complete 6 pin Assembly	Plug Assembly	Shell & Slide Assembly
6 "B" Knob	13-4566	13-4332	13-4336
6 "S", "N" Knobs	13-4564	13-4332	13-4336
7, 8, 9 Knobs	13-4568	13-4331	13-4335
7L, 8L, 10, 6500	13-4560	13-4332	13-4334
T-Zone	13-4562	13-4332	13-4334
5500	13-4570	13-4328	13-4338
7600	13-4582	13-4312	13-4339

- Available for all functions except 50 function
- Plug finishes: 4,15

### Auxiliary Locks (Deadbolts)

Locks	Complete 6 pin Assembly	Plug Assembly	Shell & Slide Assembly
464	13-4578	13-4329	13-4337
465	13-4580	13-4329	13-4337
474	13-4572	13-4330	13-4337
475, 486	13-4576	13-4330	13-4337
484	13-4572	13-4330	13-4337
485, 487	13-4574	13-4330	13-4337

- Plug finishes: 4, 15

**Note:**

Parts shown on this page are unique to the XC feature. These plugs and shells cannot be used with non-XC components. For all other cylinder components refer to the standard Cylinder & Components section. XC 11- prefix not available with 10-, 10UL-, 22-, 51-, 52-, 60-, 63-, 64-, SC- or SE- prefixes.

# XC Series Mortise/Rim Cylinders Rosettes & Blocking Rings

**SARGENT**

1-800-727-5477

www.sargentlock.com

## 11-40 Series Mortise Cylinders

Complete 6 pin Assembly	Dim. X Length Under Cylinder Head	Plug Assembly	Shell & Slide Assembly
11-41	1-1/8" (29mm)	13-4314	13-4301
11-42	1-1/4" (32mm)	13-4315	13-4302
11-43	1-3/8" (35mm)	13-4316	13-4303
11-44	1-1/2" (38mm)	13-4317	13-4304
11-46	1-3/4" (44mm)	13-4318	13-4305
11-48	2" (51mm)	13-4319	13-4306
11-50	2-1/4" (57mm)	13-4320	13-4307
11-52	2-1/2" (64mm)	13-4321	13-4308
11-54	2-3/4" (70mm)	13-4322	13-4309
11-56	3" (76mm)	13-4323	13-4310

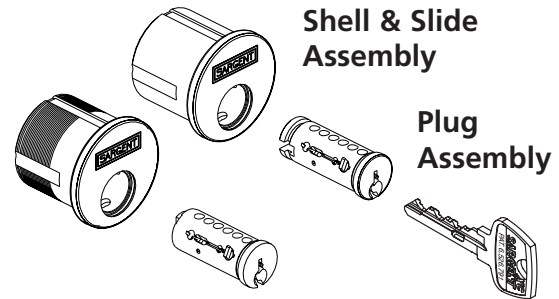

- Cylinder: Solid brass, 1-5/32" (29mm) diameter
- Cap: Brass, bronze or stainless steel
- Available for all functions except 50 function
- Furnished standard with No. 97 rosette and compression spring
- Mortise cylinder assemblies that are ordered without hardware are supplied with standard SARGENT offset cam 13-0660, except for 11-41 which uses 13-0664
- Cylinder finishes: 3, 4, 9, 10, 10B, 10BL, 20D, 26, 26D, 32, 32D
- Plug finishes: 4, 15

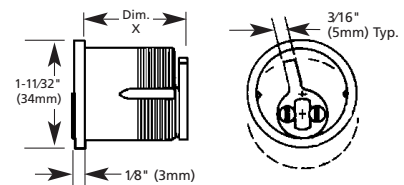

## 11-34 Rim Type Cylinders

- Complete assembly (6 pin), specify 11-34
- Plug assembly, specify 13-4312
- Shell & slide assembly, specify 13-4299
- 27/32" (21mm) screw pattern for thru bolted SARGENT exit devices
- Cylinder: Solid brass
- Cap: Brass, bronze or stainless steel
- Furnished standard with No. 97 rosette and compression spring, "break-off" screws and back plate
- Horizontal tail piece only
- Cylinder finishes: 3, 4, 9, 10, 10B, 10BL, 20D, 26, 26D, 32, 32D
- Plug finishes: 4, 15

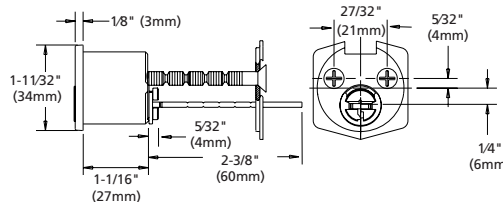

## Optional Cams for use with the 40 Series Mortise Cylinders

13-0512	Adams Rite (1850)
13-0513	Adams Rite (4070)
13-0938	Schlage L
13-0660	SARGENT standard closed
13-0664	SARGENT standard open slotted
13-0665	Inside cam for 8216 & 8292
13-0921	4370 Key switch & Russwin #11
13-0097	Misc. "open"
01-1121	Screw (2 required)

## No. 1KB Rosette



- Used with mortise cylinders and No. 90 blocking rings when cylinders project from door
- 1-1/2" (38mm) diameter, includes compression spring
- Projection from door:
 

1KB-1	5/16" (8mm)
1KB-2	7/16" (11mm)
1KB-3	9/16" (14mm)

## No. 97 Rosette



- Standard for cylinders ordered separately from hardware
- 1-11/16" diameter (43mm), 9/32" (7mm) projection, includes compression spring

## No. 90 Blocking Ring



- Used with 1KB rosettes as spacer when mortise cylinder projects from face of door
- 1-3/8" (35mm) diameter; 1/16" (1.6mm) to 3/8" (9mm) projection in 1/16" (1.6mm) increments. Specify size when ordering.

### Note:

Parts shown on this page are unique to the XC feature. These plugs and shells cannot be used with non-XC components. For all other cylinder components refer to the standard Cylinder & Components section. XC 11- prefix not available with 10-, 10UL-, 22-, 51-, 52-, 60-, 63-, 64-, SC- or SE- prefixes.



# XC Series 11-7300B Interchangeable Cores

**SARGENT**

1-800-727-5477

www.sargentlock.com

## 11-7300B Series Small Format Interchangeable Core Cylinders 6 & 7 Pin

- SARGENT Interchangeable Core Cylinders and Master Key Systems are available for increased security through quick changing of cylinders. It is unnecessary to remove the lock from a door to rekey the opening
- SARGENT 11-7300B Interchangeable Cores are available in SARGENT 4A and 4B keyways
- 4A Keyway will be supplied standard on new systems
- A2 or A4 systems available
- Existing rim and mortise cylinders require core mounting pin modification, use pin shear tool 14-2037
- Existing bored locks require new tail pieces to accept XC SFIC cores

T-Zone (11 Line)  
11-0270 (6 pin)  
11-0271 (7 pin)

10 Line  
07-0274 (6 pin)  
07-0278 (7 pin)

7 Line  
07-0271 (6 pin)  
07-0275 (7 pin)

6500 Line  
05-0039 (6 pin)  
05-0040 (7 pin)

- XC 11- prefix not available with 10-, 10UL-, 22-, 51-, 60-, 63-, 64-, SC- or SE- prefixes
- U.S. Patent No. 6,079,240

## 11-7300B Keyed Interchangeable Core

- Supplied with two nickel silver keys as standard
- Face includes SARGENT logo
- 11-7300B (6 pin)  
11-7P-7300B (7 pin)
- If Control or Master key is required order 11-6282B x Keyway
- Finishes: 4, 15

## 11-65-7300B Uncombined Interchangeable Cores

- Cores for field keying
- No pins, springs or key blanks provided
- No logo on face
- 11-65-7300B (6 pin)  
11-65-7P-7300B (7 pin)
- Finishes: 4, 15

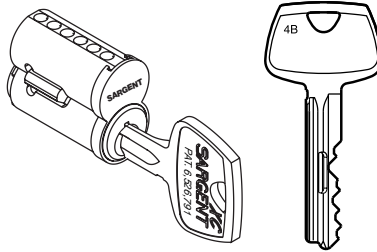

## 70- Prefix Disposable Plastic Construction Core For SFIC

- Used for those doors that do not require key locking during the construction period
- Operate with coin or flat screw driver
- Two piece design allows for easy installation
- To order separately:  
13-0964 Bottom half  
13-0965 Top half

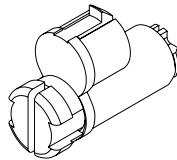

## 72- Prefix Brass Interchangeable Construction Core

- SARGENT 7200 Interchangeable brass construction core (order 72-prefix with your SARGENT products) enables doors to be locked during the construction period of a project
- Using 7200 cores prevents the keys to the permanent key system from becoming available during the construction process
- After construction is completed the 7200 brass cores are removed and replaced with 7300 keyed-permanent interchangeable cores
- Plug face is blue for easy identification
- A special Control key (7272) releases the locking sleeve of the construction core and allows for immediate removal of the core
- Construction cores are 6 pin and keyed alike
- Six (6) change keys and one (1) Control key is included
- Cores shipped with hardware

## Key Blanks/Cut Keys (Nickel Silver)

- Available in quantities of 100 each
- Same blank is cut for 6 and 7 pin systems
- Packed 50 per box
- SARGENT Keyways: 4A, 4B
- Order by  
6285B  
x Keyway
- Cut Master key 6282B  
x Keyway

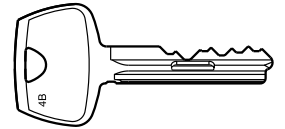

## 11-73-34 Rim Cylinder

- Brass cylinder and housing
- Furnished with No. 97 rosette, break off screws and back plate
- Housing accepts 6 or 7 pin core
- Mounting holes located to match SARGENT hardware



- Finishes: 3, 4, 26, 26D

## 11-73-40 Series Mortise Cylinders

- Two cylinder sizes
- #43, 1-3/8" (35mm) length under cylinder head including cam  
11-73-43 (6 pin)  
11-73-7P-43 (7 pin)  
11-73-43 shell less core
- #46, 1-3/4" (44mm) length under cylinder head including cam  
11-73-46 (6 pin)  
11-73-7P-46 (7 pin)  
11-70-46 shell less core
- 1-5/32" (29mm) diameter housing
- Furnished with KB-2 cylinder rosette as standard
- Cam is permanently staked to housing
- Housing accepts 6 or 7 pin cores
- Mortise cylinder cams operate current SARGENT hardware
- Hotel Function not available
- Finishes: 3, 4, 26, 26D



# XC Series 21- Prefix Construction Master Keying Padlocks

**SARGENT**

1-800-727-5477

www.sargentlock.com

## 21- Prefix Lost Ball Construction Keying

Cylinders ordered with construction keying will include the prefix 21- Lost Ball feature as standard.

With the lost ball option, construction keying is obtained without the nuisance of going back to each cylinder and removing the construction split key when the building gets turned over.

With this feature the 21- cylinder is master keyed with 3 small ball bearings in one of the chambers. The plug is drilled in two places along both sides of the same chamber containing the balls. This allows the construction master key to be used, leaving these balls in the chamber above the plug when the key is rotated.

When it is time to void the construction key, simply using the change (day) key will allow these balls to fall into the holes in the plug. Now the construction master key will no longer operate the lock.

Field construction (21- lost ball) keying can also be easily accomplished with the #439 LOST BALL REKEYING KIT. The kit includes a drilling block, knurled pin, 500 balls and drill with collar.

Orders with 21- will have all change keys shipped separately from hardware.

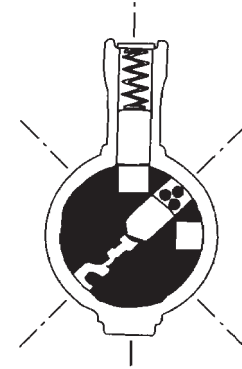

Cutaway cylinder showing construction master key being used. Note the two empty holes on either side of the chamber

### To Void Construction Key

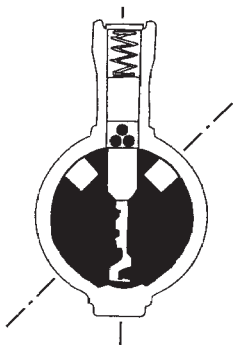

Change key inserted in cylinder.

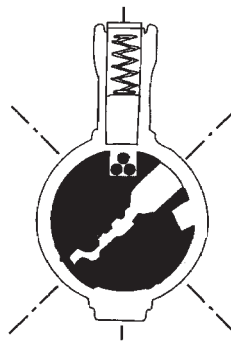

Change key rotating. Construction balls fall into hole in the side of plug.

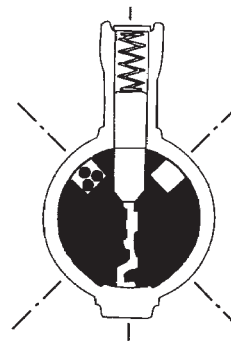

Change key rotated to position for extraction.

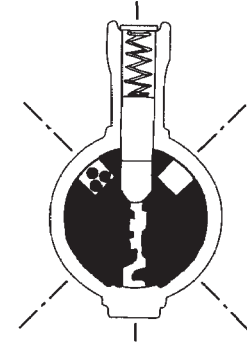

Construction key inserted after balls are trapped. Driver now extends into plug chamber. Construction key will not rotate.

## 11-758 Padlock Features

- Cylinder easily removed while in the unlocked position for rekeying
- 6 pin cylinder standard
- Shackle locked by dual ball bearings
- Higher Security key capture feature standard
- Key removable in locked position only
- All shackles 5/16" (8mm) diameter



11-758-C Shown

Complete Padlock	11-758 x Shackle height
Shackle Height (closed)	1" (25mm) standard, 2" (51mm) (-2 suffix) and 4" (102mm) (-4 suffix)
Shackle Material	Stainless steel -standard Boron hardened steel (-HS suffix) Brass chain 9" (228mm) long (-C suffix)
Cylinder assembly with tail piece	13-4584
Plug assembly	13-4332
Shell & Slide assembly	13-4334
Tail piece only	13-1230

**Note:**  
XC 11- prefix not available with 10-, 10UL-, 22-, 51-, 52-, 60-, 63-, 64-, SC- or SE- prefixes.



# XC Series Key Control Comparison Key Blanks

**SARGENT**

1-800-727-5477

www.sargentlock.com

## XC vs. Standard Keyway Control

NOTE: XC keys and master keys will operate non-XC cylinders.  
Chart shows how XC key is fully compatible with non-XC cylinders

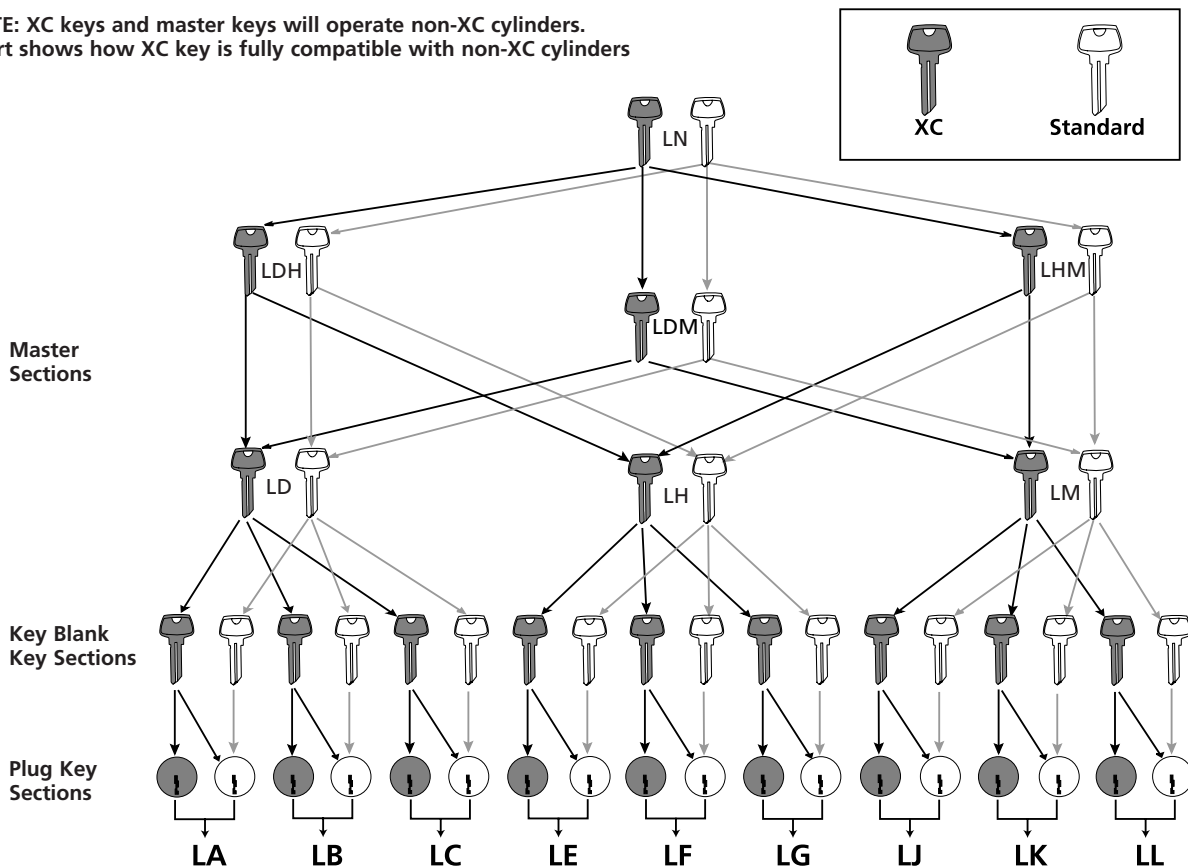

LA family shown above, also available in SARGENT R Multiplex family.  
For availability of restricted keyways, contact SARGENT Key Records Department.

### SARGENT Keyways

### Small Format Interchangeable Core Keyways

Master Key Section (6 Pin)	Day or Change Key (6 Pin)	Master/Day/Change Key (6/7 Pin)
Catalog Number 11-6270	Catalog Number 11-6275	Catalog Number 11-6285B
LD	LA RF	SARGENT 4A
LH	LB RG	SARGENT 4B
LM	LC RJ	
LDH	LE RK	
LHM	LF RL	
LN	LG	
RD	LJ	
RH	LK	
RM	LL	
RDH	RA	
RDM	RB	
RHM	RC	
RN	RE	

- Packed 50 per box
- Order by Catalog Number x Keyway
- Order cut master key as 11-6282B x Keyway

# XC Series Visual Key Control

**SARGENT**

1-800-727-5477

www.sargentlock.com

## Visual Key Control (Stamping)

To allow for more key system control with easier key and cylinder identification, SARGENT offers the option for permanent stamping of keys and/or cylinder with industry-standard alpha-numeric keyset symbols.

All SARGENT XC key blanks are identified with the following markings: "SARGENT", "XC", "PAT. 6,526,791" and "DO NOT DUPLICATE".

Change (day) keys are stamped with standard visual key control designation on second line (Item A).

Master level keys include system register numbers stamped on the first line, and the standard visual key control designations on the second line (Item B).

### Up to 7 characters available for permanent stamping for Visual Key Control

- Key and cylinder identified by industry-standard alpha-numeric keyset symbols
- Concealed stamping on mortise and rim shells available (Item C)
- Core side engraving available for 7300B Series up to 7 characters (Item D)
- Special key stampings available, such as "CITY OF PHOENIX"

**NOTE:** SARGENT will stamp alternate identity codes whenever requested. If the Visual Key Control stamping is not requested, an alternate code for stamping the individual identity of the Master Level Keys can be substituted.

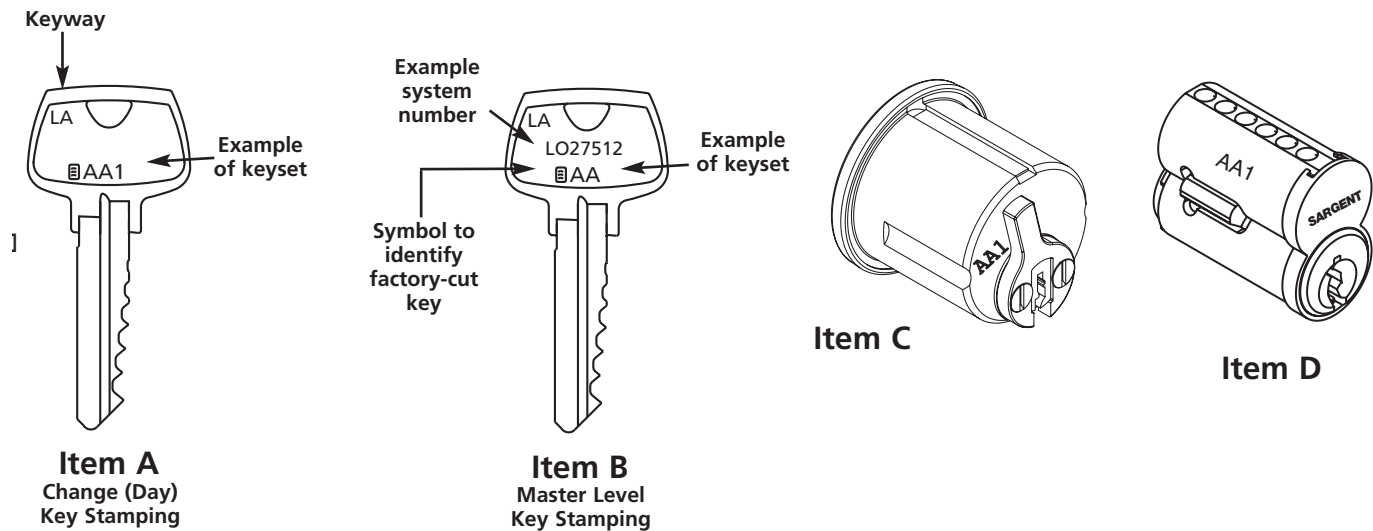

## Tamper Proof Packaging

For the highest level of security for the end user, Tamper Proof Packaging is used on all Master Keys, XC key blanks and all restricted key blanks. This heat sealed shrink wrap identified with "SARGENT Sealed For Your Security" provides assurance of the integrity of the factory generated key system.

## Architectural Specifications

---

### 2.0 CYLINDERS, KEYS, AND KEYING - Standard Cylinder (Non-removable Core)

A. Acceptable Manufacturer and Series (No Substitutions):

Manufacturer	Series
SARGENT	XC

- B. Provide cylinders and keys protected from unauthorized manufacture and distribution by manufacturer's United States patents.
- C. The key design and tolerances shall permit the cutting of keys with standard code or duplicating machines. The requirement for a single-purpose or keyway-specific cutting or duplicating machine shall not be allowed.
- D. The key design and tolerances shall permit the use of keys and cylinders in existing key systems having similar keyways and sections.
- E. Provide 6 masterkeys for each masterkey set. Provide 2 change keys for each lock. Stamp keys "DO NOT DUPLICATE".
- F. Key blanks shall only be shipped to end-user locations upon written documentation from authorized purchasing personnel and for specified number of keys only.
- G. Submit proposed keying schedule to Architect. If requested, meet with Owner and Architect to review schedule.
- H. Deliver all permanent key blanks and other security keys direct to Owner's representative from SARGENT Manufacturing via secure courier, return receipt requested. Failure to properly comply with these requirements may be cause to require replacement of all or any part of the cylinders and keys involved as deemed necessary at no additional cost to the Owner.

### 2.1 CYLINDERS, KEYS, AND KEYING - Interchangeable Core

A. Acceptable Manufacturer and Series (No Substitutions):

Manufacturer	Series
SARGENT	XC

- B. Provide 7-pin small format interchangeable core (SFIC) cylinders.
- C. Provide cylinders and keys protected from unauthorized manufacture and distribution by manufacturer's United States patents.
- D. The key design and tolerances shall permit the cutting of keys with standard code or duplicating machines. The requirement for a single-purpose or keyway-specific cutting or duplicating machine shall not be allowed.
- E. The key design and tolerances shall permit the use of keys and cylinders in existing key systems having similar keyways and sections.
- F. Provide 6 masterkeys for each masterkey set. Provide 2 change keys for each lock. Provide 2 control keys for core removal. Stamp keys "DO NOT DUPLICATE".
- G. Key blanks shall only be shipped to end-user locations upon written documentation from authorized purchasing personnel and for specified number of keys only.
- H. Submit proposed keying schedule to Architect. If requested, meet with Owner and Architect to review schedule.
- I. Deliver all permanent key blanks and other security keys direct to Owner's representative from SARGENT Manufacturing via secure courier, return receipt requested. Failure to properly comply with these requirements may be cause to require replacement of all or any part of the cylinders and keys involved as deemed necessary at no additional cost to the Owner.

## How to Order

---

A prefix has been created to assist in identifying when a SARGENT product is to include the XC cylinder feature.

When ordering, use 11- as the prefix to indicate that the product requires the XC feature.  
11-8226 LNL x 26D, 11-10G05 LL x 26D, etc.

If other prefixes are being used, be sure that the 11- prefix appears first,  
11-73-10G05, 11-21-8226 x 26D, etc.



SARGENT Manufacturing Company • 100 Sargent Drive • P.O. Box 9725 • New Haven • CT 06536-0915  
Phone: 800-727-5477 • Fax: 888-863-5054 • Web site: [www.sargentlock.com](http://www.sargentlock.com)  
SARGENT of Canada • Phone: 905-940-2040 • Fax: 905-940-3242 • Web site: [www.sargentcanada.ca](http://www.sargentcanada.ca)

Founded in 1864, SARGENT® is a market leader in locksets, cylinders, door closers, exit devices, electro-mechanical products and access control systems for new construction, renovation and replacement applications. The company's customer base includes commercial construction, institutional and industrial markets.

The ASSA ABLOY Group is the world's leading manufacturer and supplier of locking solutions, dedicated to satisfying end-user needs for security, safety and convenience.